



Development Control Committee
Thursday, 20 October 2022, 7.00 pm



**Report of the Planning Policy and
Development Manager**
Officers' Presentation (October 2022)

Application No. 22/00072/FUL

Land Adjacent to 23 Highcroft Road

Oadby

Leicestershire

LE2 4RD

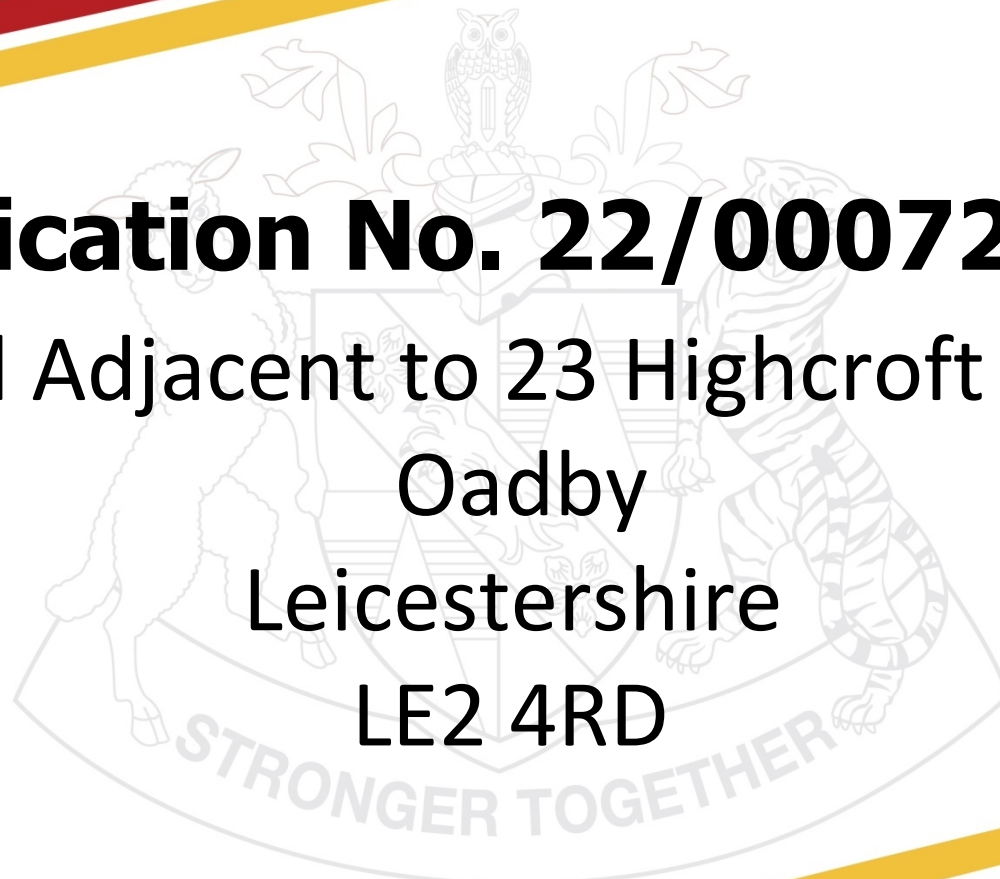

AERIAL VIEW OF SITE



SITE LOCATION PLAN

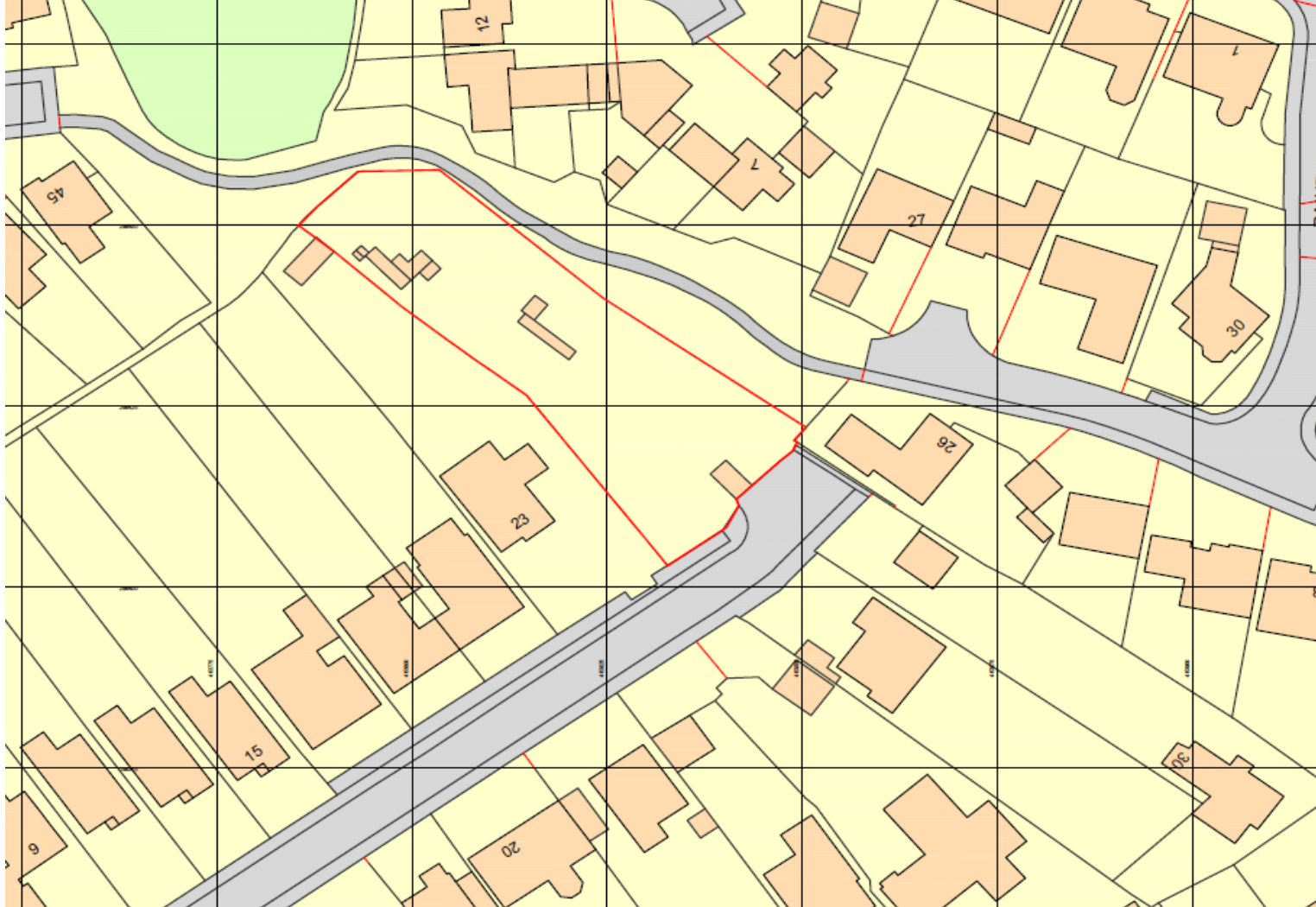

STREET SCENE FROM THE SOUTH



STREET SCENE FROM THE NORTH



STREET VIEW FRONT OF SITE



ADJACENT DWELLINGS EAST



ADJACENT DWELLINGS NORTH



ADJACENT DWELLINGS SOUTH



SITE PLAN AS SUBMITTED

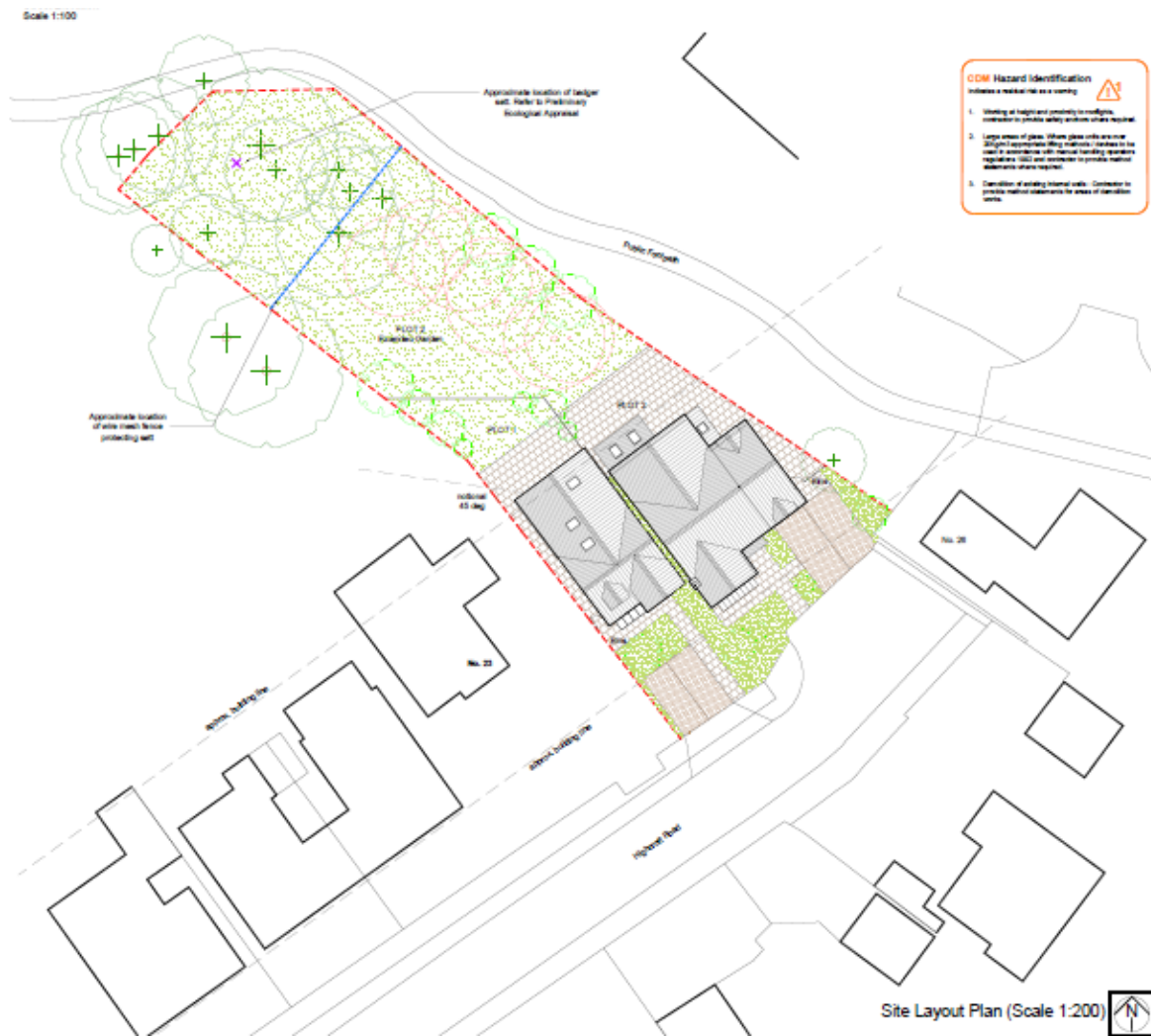

FRONT ELEVATIONS AS SUBMITTED



SITE PLAN REVISED PROPOSAL



PROPOSED FRONT ELEVATION



PROPOSED REAR ELEVATION



PROPOSED SOUTH-WEST ELEVATION



Plot 1 South West Elevation
Scale 1:100



PROPOSED NORTH – EAST ELEVATION



Plot 1 North East Elevation
Scale 1:100



PROPOSED FLOOR PLANS

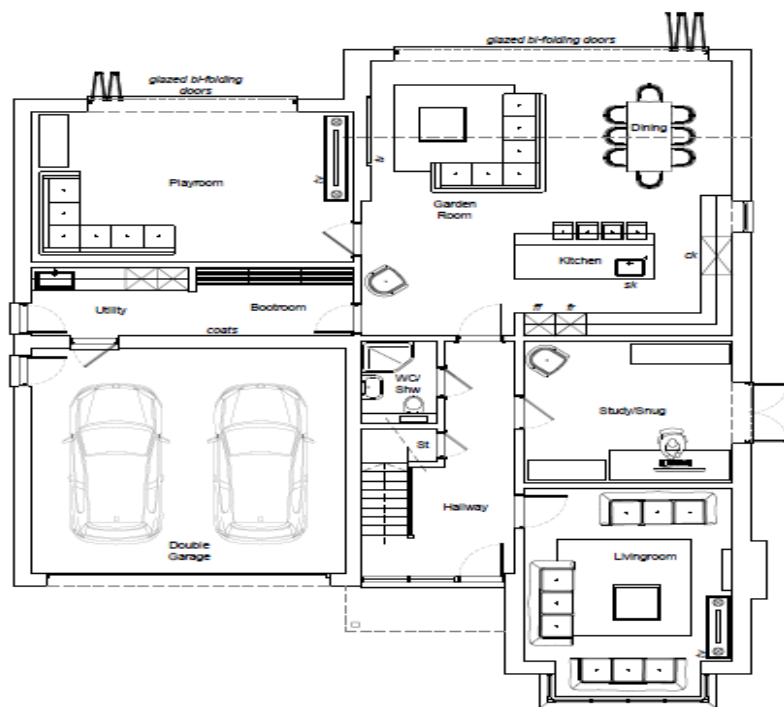

Proposed Ground Floor Plan

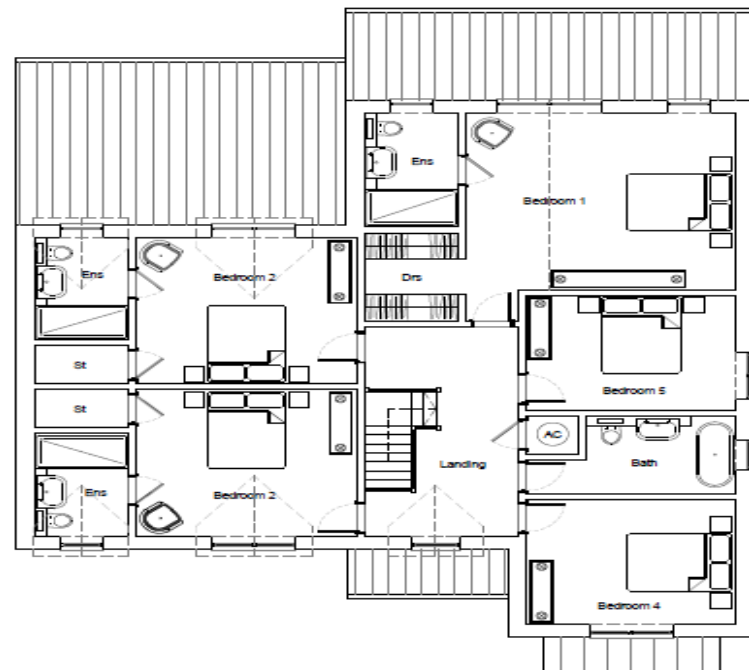
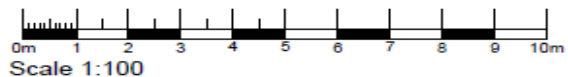

Proposed First Floor Plan

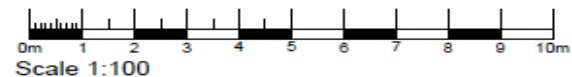

EXISTING FENCING TO REAR OF SITE



AREA OF BADGER SETT







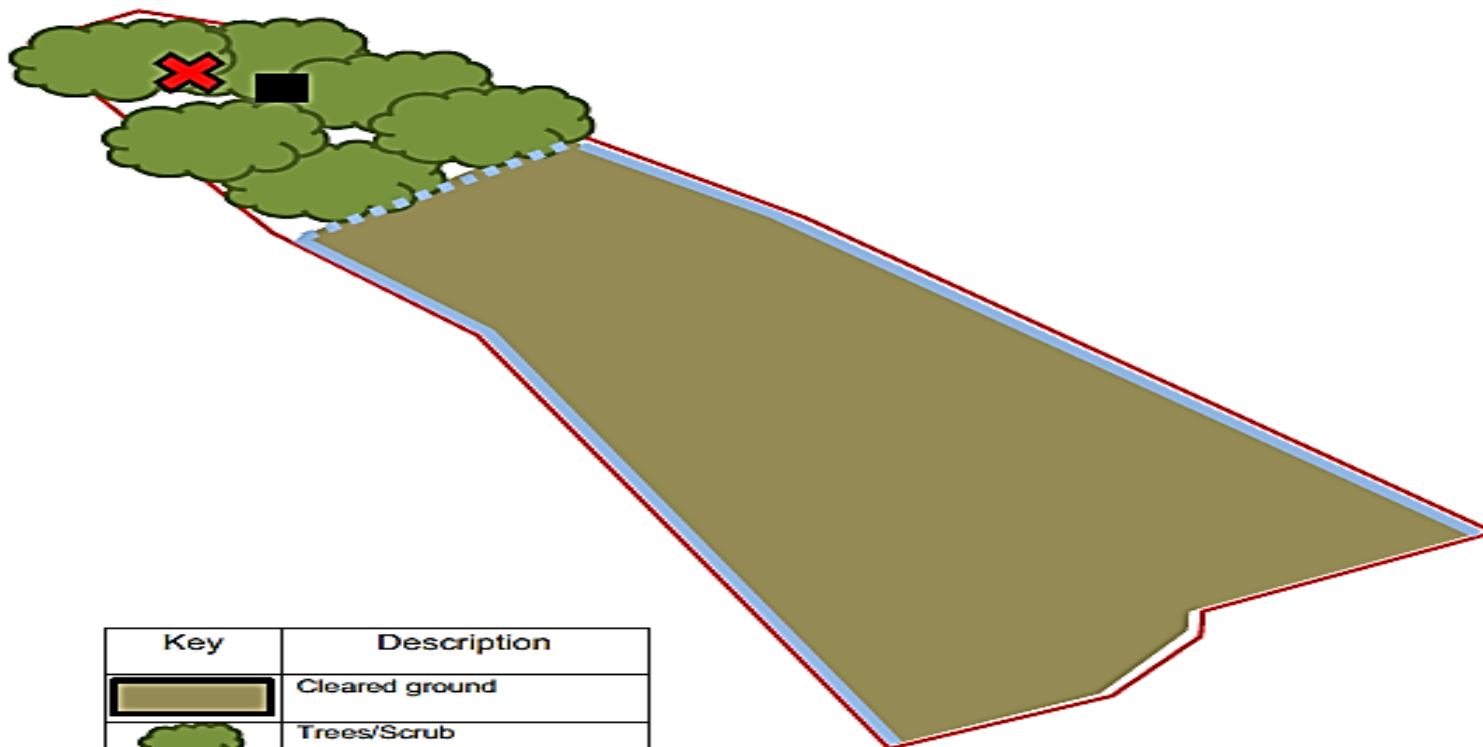

Outbuilding and badger sett area



BADGER SETT PROTECTION



Key	Description
	Cleared ground
	Trees/Scrub
	Fence boundary
	Mesh barrier protecting sett
	Building
	Badger Sett Location



SITE PLAN REVISED PROPOSAL



This page is intentionally left blank